

# COMPRESSION TUBE FITTINGS

WELLGROW INDUSTRIES CORP.

## FRT Female Run Tee

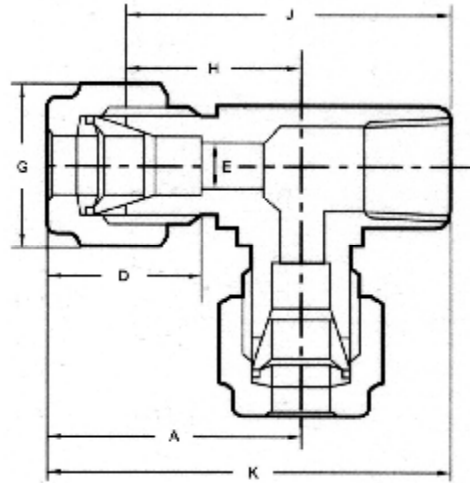

### Metric

TUBE O.D.	PIPE MALE SIZE PT/NPT	CATALOG NUMBER	A	D	E	F	G	H	J	K
6	1/8	FRT-6-1	27.0	15.3	5	14	14	19.6	38.6	46.0
6	1/4	FRT-6-2	29.8	15.3	5	17	14	22.4	44.7	52.1
6	3/8	FRT-6-3	34.6	15.3	5	22	14	27.2	58.7	57.0
6	1/2	FRT-6-4	37.7	15.3	5	27	14	30.2	41.4	66.1
8	1/8	FRT-8-1	29.9	16.2	6	14	17	22.4	41.4	48.9
8	1/4	FRT-8-2	30.6	16.2	6	17	17	23.1	45.5	53.0
8	3/8	FRT-8-3	34.0	16.2	6	22	17	26.5	54.2	61.7
8	1/2	FRT-8-4	36.8	16.2	6	27	17	29.3	61.0	68.5
10	1/8	FRT-10-1	31.5	17.2	8	17	19	23.9	42.9	50.5
10	1/4	FRT-10-2	33.5	17.2	8	17	19	25.9	48.3	55.9
10	3/8	FRT-10-3	37.5	17.2	8	22	19	29.9	57.6	65.2
10	1/2	FRT-10-4	40.3	17.2	8	27	19	32.7	64.4	72.0
12	1/8	FRT-12-1	36.0	22.8	10	22	22	25.9	48.3	58.4
12	1/4	FRT-12-2	36.0	22.8	10	22	22	25.9	48.3	58.4
12	3/8	FRT-12-3	36.0	22.8	10	22	22	25.9	48.3	58.4
12	1/2	FRT-12-4	38.8	22.8	10	27	22	28.7	57.1	67.2
12	3/4	FRT-12-6	41.8	22.8	10	32	22	31.7	64.1	74.2
14	3/8	FRT-14-3	39.8	24.4	10	27	27	29.7	55.1	65.2
14	1/2	FRT-14-4	39.8	24.4	10	27	27	29.7	58.1	68.2
14	3/4	FRT-14-6	42.8	24.4	10	32	27	32.7	65.1	75.2
15	3/8	FRT-15-3	39.8	24.4	11	27	27	29.7	55.1	65.2
15	1/2	FRT-15-4	39.8	24.4	11	27	27	29.7	58.1	68.2
15	3/4	FRT-15-6	42.8	24.4	11	32	27	32.7	65.1	75.2
16	3/8	FRT-16-3	39.8	24.4	12	27	27	29.7	55.1	65.2
16	1/2	FRT-16-4	39.8	24.4	12	27	27	29.7	58.1	68.2
16	3/4	FRT-16-6	42.8	24.4	12	27	27	32.7	65.1	75.2
18	3/8	FRT-18-3	40.5	24.4	14	27	30	30.4	55.8	65.9
18	1/2	FRT-18-4	40.5	24.4	14	27	30	30.4	58.8	68.9
18	3/4	FRT-18-6	43.5	24.4	14	32	30	33.4	65.8	75.9
20	1/2	FRT-20-4	43.5	26.0	16	32	32	33.4	64.8	74.9
20	3/4	FRT-20-6	46.5	26.0	16	32	32	36.4	71.8	81.9
22	1/2	FRT-22-4	43.5	26.0	18	32	32	33.4	64.8	74.9
22	3/4	FRT-22-6	46.5	26.0	18	32	32	36.4	71.8	81.9
25	1/2	FRT-25-4	47.5	31.3	21	34	38	35.2	68.6	80.9
25	3/4	FRT-25-6	50.5	31.3	21	34	38	38.2	75.6	87.9

# COMPRESSION TUBE FITTINGS

WELLGROW INDUSTRIES CORP.

## Fractional

TUBE O.D.	PIPE MALE SIZE PT/NPT	CATALOG NUMBER	A	D	E	F	G	H	J	K
1/4	1/8	FBT-02-1	27.0	15.2	5	14	14	19.6	38.6	46.0
1/4	1/4	FBT-02-2	29.8	15.2	5	17	14	22.4	44.7	52.1
1/4	3/8	FBT-02-3	34.6	15.2	5	22	14	27.2	49.6	57.0
1/4	1/2	FBT-02-4	37.7	15.2	5	27	14	30.2	58.7	66.1
3/8	1/8	FBT-03-1	30.5	16.8	7	17	17	23.1	42.9	50.3
3/8	1/4	FBT-03-2	31.2	16.8	7	17	17	24.0	46.4	53.6
3/8	3/8	FBT-03-3	33.3	16.8	7	22	17	26.0	48.4	55.7
3/8	1/2	FBT-03-4	36.1	16.8	7	27	17	28.7	57.1	64.2
1/2	1/8	FBT-04-1	36.0	22.8	10	22	22	25.9	48.3	58.4
1/2	1/4	FBT-04-2	36.0	22.8	10	22	22	25.9	48.3	58.4
1/2	3/8	FBT-04-3	36.0	22.8	10	22	22	26.0	48.3	58.4
1/2	1/2	FBT-04-4	38.8	22.8	10	27	22	28.7	57.1	67.2
1/2	3/4	FBT-04-6	41.8	22.8	10	32	22	31.7	64.1	74.2
3/4	1/2	FBT-06-4	39.9	24.4	15	27	30	29.7	51.8	68.3
3/4	3/4	FBT-06-6	44.7	24.4	15	32	30	34.5	66.2	76.4
1	3/4	FBT-08-6	50.5	31.3	21	34	38	38.2	75.6	87.9