

COMPRESSION TUBE FITTINGS

WELLGROW INDUSTRIES CORP.

FE Female Elbow

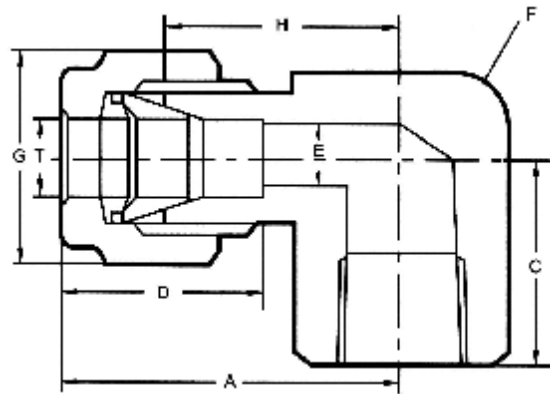
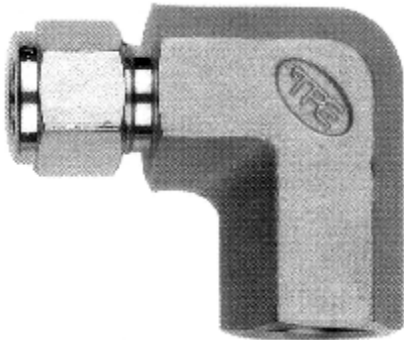

Metric

TUBE O.D.	PT-NPT MALE PIPE SIZE	CATALOG NUMBER	A	C	D	E	F	G	H
6	1/8	FE-6-1	27.0	19.1	15.3	5	14	14	19.6
6	1/4	FE-6-2	29.8	22.4	15.3	5	17	14	22.4
6	3/8	FE-6-3	34.6	22.4	15.3	5	22	14	27.2
6	1/2	FE-6-4	37.7	26.4	15.3	5	27	14	30.3
8	1/8	FE-8-1	29.3	20.0	16.2	6	14	17	21.8
8	1/4	FE-8-2	30.6	22.4	16.2	6	17	17	23.1
8	3/8	FE-8-3	34.0	27.7	16.2	6	22	17	26.5
8	1/2	FE-8-4	36.8	31.7	16.2	6	27	17	29.3
10	1/8	FE-10-1	31.5	19.0	17.2	8	17	19	23.9
10	1/4	FE-10-2	33.5	22.4	17.2	8	17	19	25.9
10	3/8	FE-10-3	37.5	27.7	17.2	8	17	19	19.9
10	1/2	FE-10-4	40.3	31.7	17.2	8	22	19	32.7
12	1/8	FE-12-1	36.0	22.4	22.8	10	22	22	25.9
12	1/4	FE-12-2	36.0	22.4	22.8	10	22	22	25.9
12	3/8	FE-12-3	36.0	22.4	22.8	10	22	22	29.9
12	1/2	FE-12-4	38.8	28.4	22.8	10	27	22	28.7
12	3/4	FE-12-6	41.8	32.4	22.8	10	32	22	31.7
14	3/8	FE-14-3	39.8	25.4	24.4	10	27	27	29.7
14	1/2	FE-14-4	39.8	28.4	24.4	10	27	27	29.7
14	3/4	FE-14-6	42.8	32.4	24.4	10	32	27	32.7
15	3/8	FE-15-3	39.8	25.4	24.4	11	27	27	29.7
15	1/2	FE-15-4	39.8	28.4	24.4	11	27	27	29.7
15	3/4	FE-15-6	42.8	32.4	24.4	11	32	27	32.7
16	3/8	FE-16-3	39.8	25.4	24.4	12	27	27	29.7
16	1/2	FE-16-4	39.5	28.4	24.4	12	27	27	29.7
16	3/4	FE-16-6	42.8	32.4	24.4	12	32	27	32.7
18	3/8	FE-18-3	40.5	25.4	24.4	14	27	30	30.4
18	1/2	FE-18-4	40.5	28.4	24.4	14	27	30	30.4
18	3/4	FE-18-6	43.5	32.4	24.4	14	32	30	33.4
20	1/2	FE-20-4	43.5	31.4	26.0	16	32	32	33.4
20	3/4	FE-20-6	46.5	35.4	26.0	16	32	32	36.4
22	1/2	FE-22-4	43.5	31.4	26.0	18	32	32	33.4
22	3/4	FE-22-6	46.5	35.4	26.0	18	32	32	36.4
25	1/2	FE-25-4	47.5	33.4	31.5	21	34	38	35.2
25	3/4	FE-25-6	50.5	37.4	31.5	21	34	38	38.2

COMPRESSION TUBE FITTINGS

WELLGROW INDUSTRIES CORP.

Fractional

TUBE O.D.	PT-NPT MALE PIPE SIZE	CATALOG NUMBER	A	C	D	E	F	G	H
1/4	1/8	FE-02-1	27.0	19.1	15.3	5	14	14	19.6
1/4	1/4	FE-02-2	29.7	22.4	15.3	5	17	14	22.4
1/4	3/8	FE-02-3	34.6	22.4	15.3	5	22	14	27.2
1/4	1/2	FE-02-4	37.7	28.4	15.3	5	27	14	30.3
3/8	1/8	FE-03-1	30.5	19.8	16.8	7	17	17	23.1
3/8	1/4	FE-03-2	31.2	22.4	16.8	7	17	17	24.0
3/8	3/8	FE-03-3	33.3	22.4	16.8	7	22	17	26.0
3/8	1/2	FE-03-4	36.1	28.4	16.8	7	27	17	28.7
1/2	1/8	FE-04-1	36.0	22.4	22.8	10	22	22	25.9
1/2	1/4	FE-04-2	36.1	22.4	22.8	10	22	22	26.0
1/2	3/8	FE-04-3	36.1	22.4	22.8	10	22	22	26.0
1/2	1/2	FE-04-4	39.0	28.4	22.8	10	27	22	28.7
1/2	3/4	FE-04-6	41.8	32.4	22.8	10	32	22	31.7
5/8	3/4	FE-05-6	42.8	32.4	24.4	12	32	27	32.7
3/4	1/2	FE-06-4	39.9	28.4	24.4	15	27	30	29.7
3/4	3/4	FE-06-6	44.7	32.4	24.4	15	32	30	34.5
1	3/4	FE-08-6	49.0	32.4	31.3	21	34	38	36.8