

# COMPRESSION TUBE FITTINGS

WELLGROW INDUSTRIES CORP.

## Instrument Needle Valve, Integral Bonnet, Forged Body, Tube OD

### Features

1. Forged or Bar Stock body construction.
2. Metal to metal or stellite seat for high pressure.
3. Straight Pattern with panel mounting optional.
4. One piece or non-regulating Vee tip, non-rotating ball tip optional.
5. Variety of end connections: female NPT and ISO, DIN and JIS tapered pipe ends.
6. Maximum Working Pressure: 6000PSI (414bar) at 200°C
7. 100% factory tested.

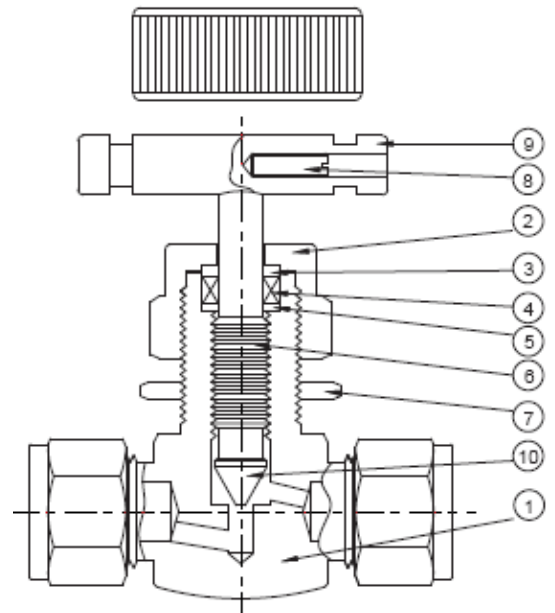
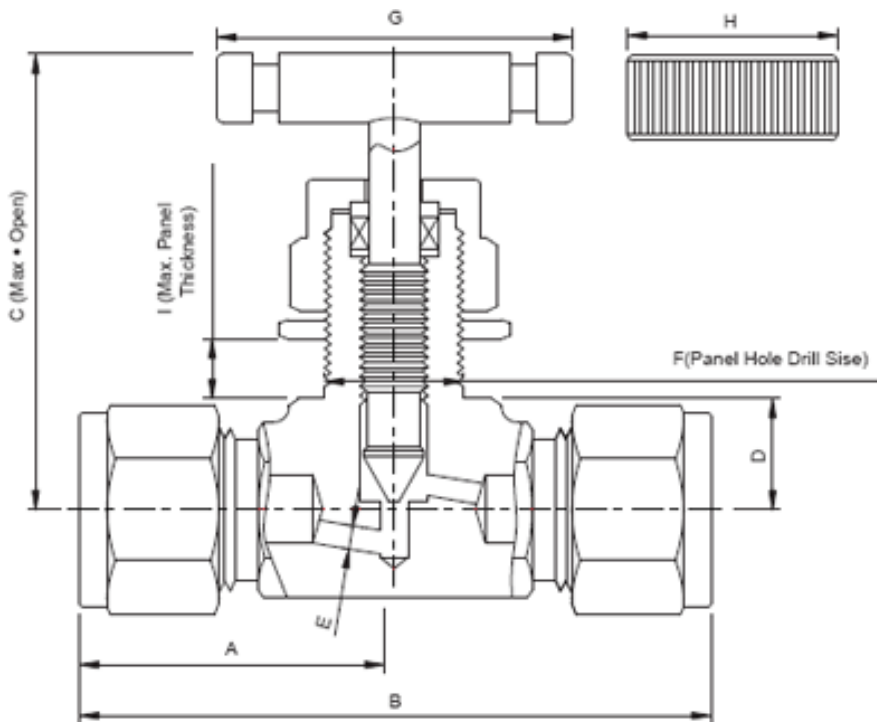

### Dimension

SIZE	END CONNECTION (INLET X OUTLET)	A	B	C	D	E	F	G	H	I
1/4"	MNPT	27.5	55	50	12	3.5	14	60	32	5
3/8"	MNPT	32	64	50	12	3.5	14	60	32	5
1/2"	MNPT	36.5	73	54	16	5	16	60	32	5
1/4"	FNPT	27.5	55	50	12	3.5	14	60	32	5
3/8"	FNPT	32	64	50	12	5	16	60	32	5
1/4"	MNPT X FNPT	27.5	55	50	12	3.5	14	60	32	5
3/8"	MNPT X FNPT	32	64	50	12	3.5	14	60	32	5
1/2"	MNPT X FNPT	36.5	73	54	16	5	16	60	32	5
1/4"	Wellgrow Tube End	34.5	69	50	12	3.5	14	60	32	5
3/8"	Wellgrow Tube End	34.5	69	50	12	3.5	14	60	32	5
1/2"	Wellgrow Tube End	45.5	91	54	16	5	16	60	32	5
3/4"	Wellgrow Tube End	45.5	91	56	18	5	16	60	32	5
1"	Wellgrow Tube End	50	100	60.5	22.5	10	16	60	32	5
6MM	Wellgrow Tube End	34.3	68.5	50	12	3.5	14	60	32	5
8MM	Wellgrow Tube End	35	70	50	12	3.5	14	60	32	5
10MM	Wellgrow Tube End	38	76	50	12	3.5	14	60	32	5
12MM	Wellgrow Tube End	45.5	91	54	16	5	16	60	32	5
16MM	Wellgrow Tube End	45.5	91	56	18	5	16	60	32	5
22MM	Wellgrow Tube End	50	100	58.5	20.5	10	16	60	32	5
25MM	Wellgrow Tube End	50	100	63	25	10	16	60	32	5

### Material List

NO.	PART NAME	MATERIAL
1	BODY	SS316 / SS304
2	BONNET	SS316 / SS304
3	WASHER	SS316 / SS304
4	PACKING	PTFE / GRAFOIL
5	PACKING WASHER	SS316 / SS304
6	STEM	SS316 / SS304
7	LOCK NUT	SS316 / SS304
8	GRUB SCREW	SS304
9	HANDLE	SS304
10	VEE TIP STEM	SS316 / SS304