

SANITARY STAINLESS STEEL FITTINGS & VALVES

WELLGROW INDUSTRIES CORP.

BPE Fittings

BPE 45° Elbow Clamp End (DT-17)

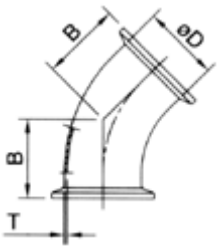

SIZE	D	B	T
1/2"	12.7	25.40	1.65
3/4"	19.05	25.40	1.65
1"	25.4	28.40	1.65
1-1/2"	38.1	36.58	1.65
2"	50.8	44.45	1.65
2-1/2"	63.5	52.32	1.65
3"	76.2	60.45	1.65
4"	101.6	79.25	2.10

BPE 90° Elbow Clamp End (DT-16)

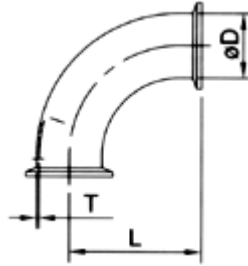

SIZE	D	L	T
1/2"	12.7	41.15	1.65
3/4"	19.05	41.15	1.65
1"	25.4	50.80	1.65
1-1/2"	38.1	69.85	1.65
2"	50.8	88.90	1.65
2-1/2"	63.5	107.95	1.65
3"	76.2	127.00	1.65
4"	101.6	168.30	2.10

BPE Equal Tee Clamp End (DT-18)

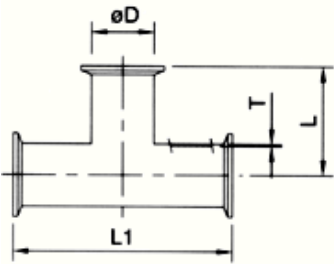

SIZE	D	L	L1	T
1/2"	12.7	57.20	114.4	1.65
3/4"	19.05	60.20	120.6	1.65
1"	25.4	66.55	133.4	1.65
1-1/2"	38.1	72.90	146.0	1.65
2"	50.8	85.60	171.4	1.65
2-1/2"	63.5	92.95	182.2	1.65
3"	76.2	98.30	196.8	1.65
4"	101.6	120.65	241.4	2.10

BPE Equal Cross Clamp End (DT-18)

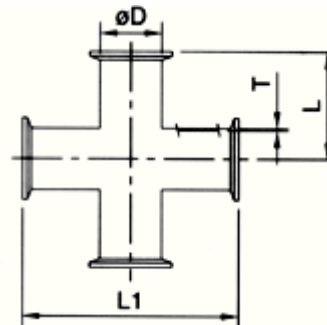

SIZE	D	L	L1	T
1/2"	12.7	57.20	114.4	1.65
3/4"	19.05	60.20	120.6	1.65
1"	25.4	66.55	133.4	1.65
1-1/2"	38.1	72.90	146.0	1.65
2"	50.8	85.60	171.4	1.65
2-1/2"	63.5	92.95	182.2	1.65
3"	76.2	98.30	196.8	1.65
4"	101.6	120.65	241.4	2.10

BPE Short Outlet Tee Clamp End (DT-27)



SIZE	D	L	L1	T
1/2"	12.7	57.2	25.4	1.65
3/4"	19.05	60.3	28.6	1.65
1"	25.4	66.7	28.6	1.65
1-1/2"	38.1	73.0	34.9	1.65
2"	50.8	85.7	41.3	1.65
2-1/2"	63.5	92.1	47.6	1.65
3"	76.2	98.4	54.0	1.65
4"	101.6	120.7	69.9	2.10

BPE 180° U-Joint Clamp End (DT-24)

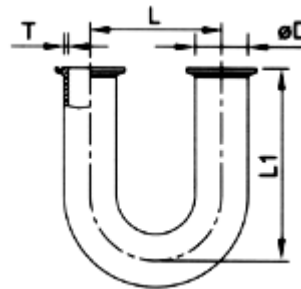

SIZE	D	L	L1	T
1/2"	12.7	114.3	88.9	1.65
3/4"	19.05	114.3	88.9	1.65
1"	25.4	114.3	88.9	1.65
1-1/2"	38.1	114.3	127.0	1.65
2"	50.8	152.4	139.7	1.65
2-1/2"	63.5	190.5	158.8	1.65
3"	76.2	228.6	177.8	1.65
4"	101.6	304.8	231.8	2.10

SANITARY STAINLESS STEEL FITTINGS & VALVES

WELLGROW INDUSTRIES CORP.

BPE Fittings

BPE Reducing Tee Clamp End (DT-19)

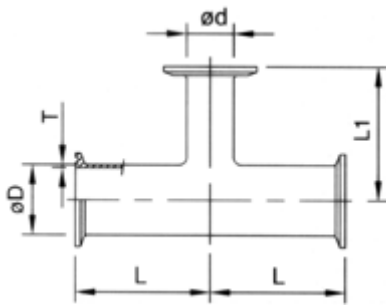

SIZE	D	d	L	L1	T
3/4" x 1/2"	19.05	12.7	63.5	63.5	1.65
1" x 1/2"	25.40	12.7	66.7	66.7	1.65
1" x 3/4"	25.40	19.05	66.7	66.7	1.65
1-1/2" x 1/2"	38.10	12.7	73.0	73.0	1.65
1-1/2" x 3/4"	38.10	19.05	73.0	73.0	1.65
1-1/2" x 1"	38.10	25.4	73.0	73.0	1.65
2" x 1"	50.80	25.4	85.7	79.4	1.65
2" x 1-1/2"	50.80	38.1	85.7	79.4	1.65
2-1/2" x 1"	63.50	25.4	92.1	85.7	1.65
2-1/2" x 1-1/2"	63.50	38.1	92.1	85.7	1.65

SIZE	D	d	L	L1	T
2-1/2" x 2"	63.5	50.8	92.1	85.7	1.65
3" x 1"	76.2	25.4	98.4	92.1	1.65
3" x 1-1/2"	76.2	38.1	98.4	92.1	1.65
3" x 2"	76.2	50.8	98.4	98.4	1.65
3" x 2-1/2"	76.2	63.5	98.4	98.4	1.65
4" x 1"	101.6	25.4	120.7	104.8	2.10
4" x 1-1/2"	101.6	38.1	120.7	104.8	2.10
4" x 2"	101.6	50.8	120.7	111.1	2.10
4" x 2-1/2"	101.6	63.5	120.7	111.1	2.10
4" x 3"	101.6	76.2	120.7	111.1	2.10

BPE Short Outlet Reducing Tee Clamp End (DT-20)

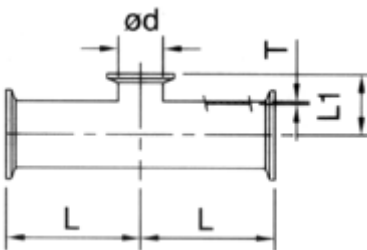

SIZE	D	d	L	L1	T
3/4" x 1/2"	19.05	12.7	63.5	25.4	1.65
1" x 1/2"	25.4	12.7	66.7	28.6	1.65
1" x 3/4"	25.4	19.05	66.7	28.6	1.65
1-1/2" x 1/2"	38.1	12.7	73.0	34.9	1.65
1-1/2" x 3/4"	38.1	19.05	73.0	34.9	1.65
1-1/2" x 1"	38.1	25.4	73.0	34.9	1.65
2" x 1"	50.8	25.4	85.7	47.6	1.65
2" x 1-1/2"	50.8	38.1	92.1	47.6	1.65
2-1/2" x 1"	63.5	25.4	92.1	47.6	1.65
2-1/2" x 1-1/2"	63.5	38.1	92.1	47.6	1.65

SIZE	D	d	L	L1	T
2-1/2" x 2"	63.5	50.8	92.1	47.6	1.65
3" x 1"	76.2	25.4	98.4	54.0	1.65
3" x 1-1/2"	76.2	38.1	98.4	54.0	1.65
3" x 2"	76.2	50.8	98.4	54.0	1.65
3" x 2-1/2"	76.2	63.5	98.4	54.0	1.65
4" x 1"	101.6	25.4	120.7	66.7	2.10
4" x 2-1/2"	101.6	38.1	120.7	66.7	2.10
4" x 2"	101.6	50.8	120.7	66.7	2.10
4" x 2-1/2"	101.6	63.5	120.7	66.7	2.10
4" x 3"	101.6	76.2	120.7	66.7	2.10

BPE Concentric Reducer Clamp End (DT-21)

BPE Eccentric Reducer Clamp End (DT-21)

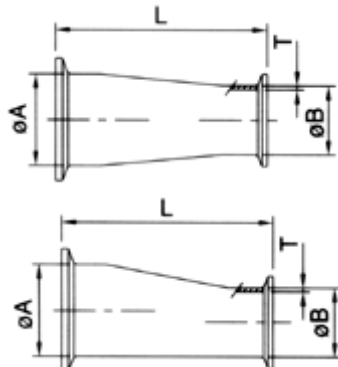

SIZE	A	B	L	T
3/4" x 1/2"	19.05	12.7	50.8	1.65
1" x 1/2"	25.4	12.7	63.5	1.65
1" x 3/4"	25.4	19.1	50.8	1.65
1-1/2" x 1/2"	38.1	12.7	88.9	1.65
1-1/2" x 3/4"	38.1	19.1	76.2	1.65
1-1/2" x 1"	38.1	25.4	76.2	1.65
2" x 1/2"	50.8	12.7	139.7	1.65
2" x 3/4"	50.8	19.05	127.0	1.65
2" x 1"	50.8	25.4	127.0	1.65
2" x 1-1/2"	50.8	38.1	76.2	1.65

SIZE	A	B	L	T
2-1/2" x 1-1/2"	63.5	38.1	127.0	1.65
2-1/2" x 2"	63.5	50.8	76.2	1.65
3" x 1-1/2"	76.2	38.1	177.8	1.65
3" x 2"	76.2	50.8	127.0	1.65
3" x 2-1/2"	76.2	63.5	76.2	1.65
4" x 1-1/2"	101.6	38.1	282.6	2.10
4" x 2"	101.6	50.8	231.8	2.10
4" x 2-1/2"	101.6	63.5	181.0	2.10
4" x 3"	101.6	76.2	130.2	2.10

SANITARY STAINLESS STEEL FITTINGS & VALVES

WELLGROW INDUSTRIES CORP.

BPE Fittings

BPE 45° Elbow Weld End (DT-8)

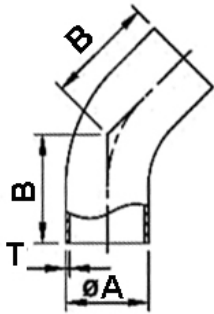

SIZE	A	B	T
1/2"	12.7	57.15	1.65
3/4"	19.05	57.15	1.65
1"	25.4	57.15	1.65
1-1/2"	38.1	63.50	1.65
2"	50.8	76.20	1.65
2-1/2"	63.5	85.60	1.65
3"	76.2	91.95	1.65
4"	101.6	114.30	2.10

BPE 90° Elbow Weld End (DT-7)

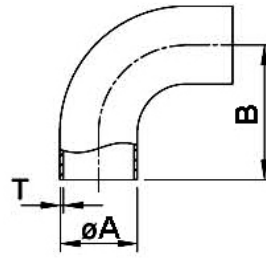

SIZE	A	B	T
1/2"	12.7	76.20	1.65
3/4"	19.05	76.20	1.65
1"	25.4	76.20	1.65
1-1/2"	38.1	95.25	1.65
2"	50.8	120.65	1.65
2-1/2"	63.5	139.70	1.65
3"	76.2	158.75	1.65
4"	101.6	203.20	2.10

BPE Equal Tee Weld End (DT-9)

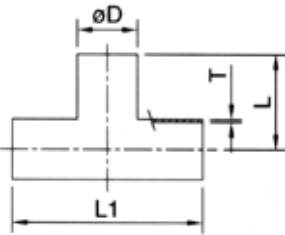

SIZE	D	L	L1	T
1/2"	12.7	47.50	95.2	1.65
3/4"	19.05	50.80	101.6	1.65
1"	25.4	53.85	108.0	1.65
1-1/2"	38.1	60.20	120.6	1.65
2"	50.8	73.00	146.0	1.65
2-1/2"	63.5	79.25	158.8	1.65
3"	76.2	85.60	171.4	1.65
4"	101.6	104.65	209.6	2.10

BPE Equal Cross Weld End (DT-9)

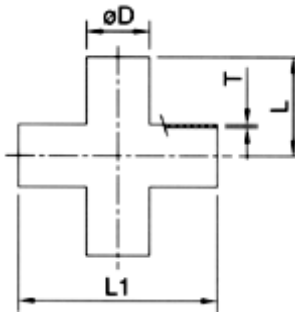

SIZE	D	L	L1	T
1/2"	12.7	47.50	95.2	1.65
3/4"	19.05	50.80	101.6	1.65
1"	25.4	53.85	108.0	1.65
1-1/2"	38.1	60.20	120.6	1.65
2"	50.8	73.00	146.0	1.65
2-1/2"	63.5	79.25	158.8	1.65
3"	76.2	85.60	171.4	1.65
4"	101.6	104.65	209.6	2.10

BPE Reducing Tee Weld End (DT-10)

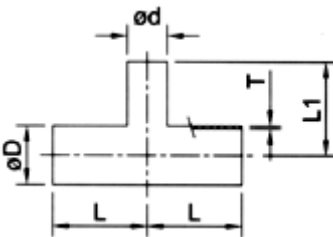

SIZE	D	d	L	L1	T
3/4" x 1/2"	19.05	12.7	50.8	50.80	1.65
1" x 1/2"	25.4	12.7	54.0	53.85	1.65
1" x 3/4"	25.4	19.05	54.0	53.85	1.65
1-1/2" x 1/2"	38.1	12.7	60.3	60.20	1.65
1-1/2" x 3/4"	38.1	19.05	60.3	60.20	1.65
1-1/2" x 1"	38.1	25.4	60.3	60.20	1.65
2" x 1/2"	50.8	12.7	72.9	66.55	1.65
2" x 3/4"	50.8	19.05	72.9	66.55	1.65
2" x 1"	50.8	25.4	72.9	66.55	1.65
2" x 1-1/2"	50.8	38.1	72.9	66.55	1.65
2-1/2" x 1/2"	63.5	12.7	79.25	72.90	1.65
2-1/2" x 3/4"	63.5	19.05	79.25	72.90	1.65
2-1/2" x 1"	63.5	25.4	79.25	72.90	1.65

SIZE	D	d	L	L1	T
2-1/2" x 1-1/2"	63.5	38.1	79.4	73.0	1.65
2-1/2" x 2"	63.5	50.8	79.4	73.0	1.65
3" x 1/2"	76.2	12.7	85.6	79.25	1.65
3" x 3/4"	76.2	19.05	85.6	79.25	1.65
3" x 1"	76.2	25.4	85.6	79.25	1.65
3" x 1-1/2"	76.2	38.1	85.6	79.25	1.65
3" x 2"	76.2	50.8	85.6	79.25	1.65
3" x 2-1/2"	76.2	63.5	85.6	79.25	1.65
4" x 1"	101.6	25.4	104.65	91.95	2.10
4" x 1-1/2"	101.6	38.1	104.65	91.95	2.10
4" x 2"	101.6	50.8	104.65	98.30	2.10
4" x 2-1/2"	101.6	63.5	104.65	98.30	2.10
4" x 3"	101.6	76.2	104.65	98.30	2.10

BPE Equal Outlet Tee Weld/ Clamp End (DT-15)

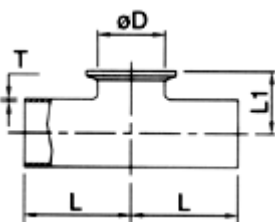

SIZE	D	L	L1	T
1/2"	12.7	47.6	25.4	1.65
3/4"	19.05	50.8	28.6	1.65
1"	25.4	54.0	28.6	1.65
1-1/2"	38.1	60.3	34.9	1.65
2"	50.8	73.0	41.3	1.65
2-1/2"	63.5	79.4	47.6	1.65
3"	76.2	85.7	54.0	1.65
4"	101.6	104.8	69.9	2.10

BPE 180° U-Joint Weld End (DT-23)

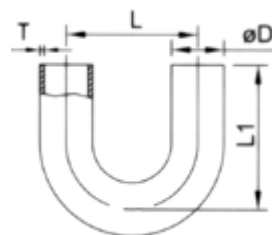

SIZE	D	L	L1	T
1/2"	12.7	114.3	76.2	1.65
3/4"	19.05	114.3	76.2	1.65
1"	25.4	114.3	76.2	1.65
1-1/2"	38.1	152.4	114.3	1.65
2"	50.8	152.4	127.0	1.65
2-1/2"	63.5	190.5	146.1	1.65
3"	76.2	228.6	165.1	1.65
4"	101.6	304.8	215.9	2.10

SANITARY STAINLESS STEEL FITTINGS & VALVES

WELLGROW INDUSTRIES CORP.

BPE Fittings

BPE Concentric Reducer Weld End (DT-11)
BPE Eccentric Reducer Weld End (DT-11)

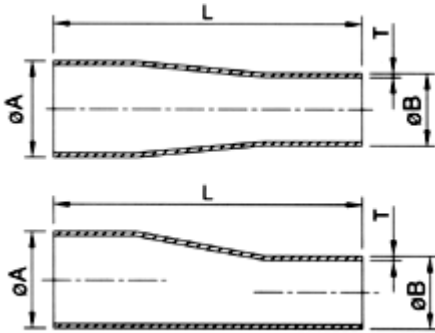

SIZE	A	B	L	T
3/4" x 1/2"	19.05	12.7	101.60	1.65
1" x 1/2"	25.4	12.7	114.30	1.65
1" x 3/4"	25.4	19.1	101.60	1.65
1-1/2" x 1/2"	38.1	12.7	139.70	1.65
1-1/2" x 3/4"	38.1	19.1	127.00	1.65
1-1/2" x 1"	38.1	25.4	127.00	1.65
2" x 1/2"	50.8	12.7	196.85	1.65
2" x 3/4"	50.8	19.05	184.25	1.65
2" x 1"	50.8	25.4	184.25	1.65
2" x 1-1/2"	50.8	38.1	184.25	1.65

SIZE	A	B	L	T
2-1/2" x 1-1/2"	63.5	38.1	184.2	1.65
2-1/2" x 2"	63.5	50.8	139.7	1.65
3" x 1-1/2"	76.2	38.1	235.0	1.65
3" x 2"	76.2	50.8	190.5	1.65
3" x 2-1/2"	76.2	63.5	139.7	1.65
4" x 1-1/2"	101.6	38.1	342.9	2.10
4" x 2"	101.6	50.8	299.7	2.10
4" x 2-1/2"	101.6	63.5	247.7	2.10
4" x 3"	101.6	76.2	196.9	2.10

BPE 45° Elbow Weld/ Clamp End (DT-13)

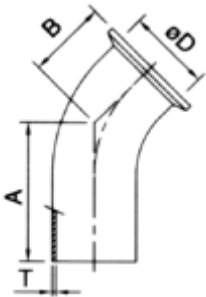

SIZE	D	A	B	T
1/2"	12.7	57.15	25.40	1.65
3/4"	19.05	57.15	25.40	1.65
1"	25.4	57.15	28.45	1.65
1-1/2"	38.1	63.50	36.80	1.65
2"	50.8	76.20	44.45	1.65
2-1/2"	63.5	85.60	52.32	1.65
3"	76.2	91.95	60.45	1.65
4"	101.6	114.3	79.25	2.10

BPE 90° Elbow Weld/ Clamp End (DT-12)

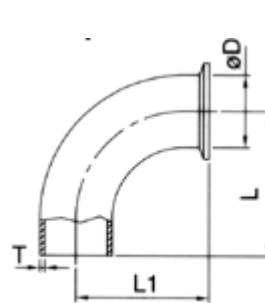

SIZE	D	L	L1	T
1/2"	12.7	76.20	41.15	1.65
3/4"	19.05	76.20	41.15	1.65
1"	25.4	76.20	50.80	1.65
1-1/2"	38.1	95.25	69.85	1.65
2"	50.8	120.65	88.90	1.65
2-1/2"	63.5	139.70	107.95	1.65
3"	76.2	158.75	127.00	1.65
4"	101.6	203.20	168.15	2.10

BPE Short Outlet Reducing Tee Weld/ Clamp End (DT-14)

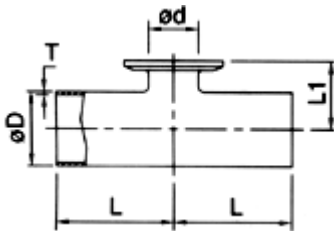

SIZE	D	d	L	L1	T
3/4" x 1/2"	19.05	12.7	50.80	25.4	1.65
1" x 1/2"	25.4	12.7	53.84	28.6	1.65
1" x 3/4"	25.4	19.05	53.84	28.6	1.65
1-1/2" x 1/2"	38.1	12.7	60.2	34.9	1.65
1-1/2" x 3/4"	38.1	19.05	62.2	34.9	1.65
1-1/2" x 1"	38.1	25.4	60.2	34.9	1.65
2" x 1/2"	50.8	12.7	72.9	41.3	1.65
2" x 3/4"	50.8	19.05	72.9	41.3	1.65
2" x 1"	50.8	25.4	72.9	41.3	1.65
2" x 1-1/2"	63.5	38.1	72.9	41.3	1.65
2-1/2" x 1/2"	63.5	12.7	79.25	47.6	1.65
2-1/2" x 3/4"	63.5	19.05	79.25	47.6	1.65
2-1/2" x 1"	63.5	25.4	79.25	47.6	1.65

SIZE	D	d	L	L1	T
2-1/2" x 1-1/2"	63.5	38.1	79.4	47.6	1.65
2-1/2" x 2"	63.5	50.8	79.4	47.6	1.65
3" x 1/2"	76.2	12.7	85.7	54.0	1.65
3" x 3/4"	76.2	19.05	85.7	54.0	1.65
3" x 1"	76.2	25.4	85.7	54.0	1.65
3" x 1-1/2"	76.2	38.1	85.7	54.0	1.65
3" x 2"	76.2	50.8	85.7	54.0	1.65
3" x 2-1/2"	76.2	63.5	85.7	54.0	1.65
4" x 1"	101.6	25.4	104.8	66.7	2.10
4" x 1-1/2"	101.6	38.1	104.8	66.7	2.10
4" x 2"	101.6	50.8	104.8	66.7	2.10
4" x 2-1/2"	101.6	63.5	104.8	66.7	2.10
4" x 3"	101.6	76.2	104.8	66.7	2.10

SANITARY STAINLESS STEEL FITTINGS & VALVES

WELLGROW INDUSTRIES CORP.

BPE Fittings

BPE Instrument Tee Weld/ Clamp End (DT-28/29)

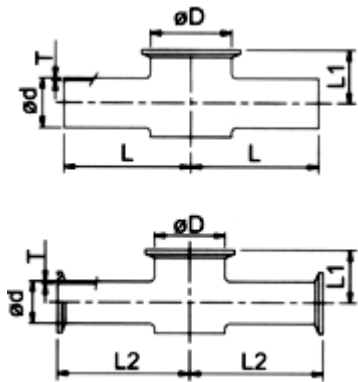

SIZE	D	d	L	L1	L2	T
1" x 1/2"	25.4	12.7	63.5	22.2	77	1.65
1" x 3/4"	25.4	19.05	63.5	25.4	77	1.65
1-1/2" x 1/2"	38.1	12.7	63.5	22.2	76.2	1.65
1-1/2" x 3/4"	38.1	19.05	63.5	25.4	76.2	1.65
1-1/2" x 1"	38.1	25.4	63.5	28.6	76.2	1.65
2" x 1/2"	50.8	12.7	69.9	25.4	82.6	1.65
2" x 3/4"	50.8	19.05	69.9	28.6	82.6	1.65
2" x 1"	50.8	25.4	69.9	31.8	82.6	1.65
2" x 1-1/2"	50.8	38.1	69.9	38.1	82.6	1.65
2-1/2" x 1/2"	63.5	12.7	85.0	35.0	97.0	1.65
2-1/2" x 3/4"	63.5	19.05	85.0	38.6	97.0	1.65
2-1/2" x 1"	63.5	25.4	85.0	41.3	97.0	1.65
2-1/2" x 1-1/2"	63.5	38.1	85.0	44.5	97.0	1.65
2-1/2" x 2"	63.5	50.8	85.0	48.0	97.0	1.65

SIZE	D	d	L	L1	L2	T
3" x 1/2"	76.2	12.7	90	38.1	102	1.65
3" x 3/4"	76.2	19.05	90	41.3	102	1.65
3" x 1"	76.2	25.4	90	44.5	102	1.65
3" x 1-1/2"	76.2	38.1	90	48.0	102	1.65
3" x 2"	76.2	50.8	90	50.8	102	1.65
3" x 2-1/2"	76.2	63.5	90	54.0	102	1.65
4" x 1/2"	101.6	12.7	110	79.4	122	1.65
4" x 3/4"	101.6	19.05	110	82.6	122	1.65
4" x 1"	101.6	25.4	110	85.7	122	1.65
4" x 1-1/2"	101.6	38.1	110	88.7	122	1.65
4" x 2"	101.6	50.8	110	95.2	122	1.65
4" x 2-1/2"	101.6	63.5	110	98.4	122	1.65
4" x 3"	101.6	76.2	110	101.6	122	1.65

BPE Concentric and Eccentric Reducer Weld/ Clamp End (DT-26)

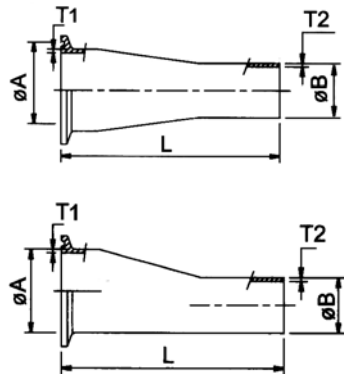

SIZE	A	B	L	T1	T2
3/4" x 1/2"	19.05	12.7	76.2	1.65	1.65
1" x 1/2"	25.4	12.7	88.9	1.65	1.65
1" x 3/4"	25.4	19.05	76.2	1.65	1.65
1-1/2" x 1/2"	38.1	12.7	114.3	1.65	1.65
1-1/2" x 3/4"	38.1	19.05	101.6	1.65	1.65
1-1/2" x 1"	38.1	25.4	101.6	1.65	1.65
2" x 1/2"	50.8	12.7	165.4	1.65	1.65
2" x 3/4"	50.8	19.05	152.4	1.65	1.65
2" x 1"	50.8	25.4	152.4	1.65	1.65
2" x 1-1/2"	50.8	38.1	101.6	1.65	1.65

SIZE	A	B	L	T1	T2
2-1/2" x 1-1/2"	63.5	38.1	152.4	1.65	1.65
2-1/2" x 2"	63.5	50.8	108.0	1.65	1.65
3" x 1-1/2"	76.2	38.1	203.2	1.65	1.65
3" x 2"	76.2	50.8	158.8	1.65	1.65
3" x 2-1/2"	76.2	63.5	108.0	1.65	1.65
4" x 1-1/2"	101.6	38.1	308.0	2.10	1.65
4" x 2"	101.6	50.8	263.5	2.10	1.65
4" x 2-1/2"	101.6	63.5	212.7	2.10	1.65
4" x 3"	101.6	76.2	161.9	2.10	1.65

BPE Short Outlet Run Tee Weld/ Clamp End (DT-25)

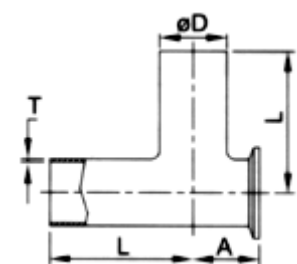

SIZE	D	A	L	T
1/2"	12.7	22.2	47.6	1.65
3/4"	19.05	25.4	50.8	1.65
1"	25.4	28.6	54.0	1.65
1-1/2"	38.1	34.9	60.3	1.65
2"	50.8	41.3	73.0	1.65
2-1/2"	63.5	47.6	79.4	1.65
3"	76.2	54.0	85.7	1.65
4"	101.6	69.9	104.8	2.10