

FE Female Elbow

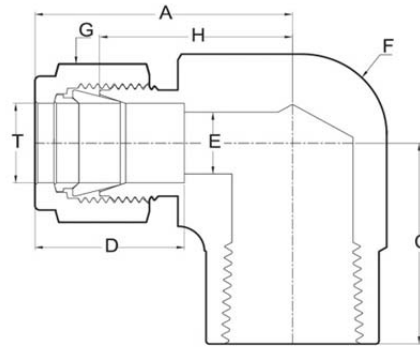

Metric

TUBE O.D.	FEMALE PIPE SIZE	ITEM NUMBER	A	C	D	E	F	G	H
4	1/8	FE-4-1	25.4	19.3	13.7	2.5	14	12	18.3
4	1/4	FE-4-2	27.8	23.7	13.7	2.5	17	12	20.7
4	3/8	FE-4-3	30.5	26.4	13.7	2.5	22	12	23.4
4	1/2	FE-4-4	33.7	32.6	13.7	2.5	27	12	26.6
6	1/8	FE-6-1	26.9	19.3	15.3	5.0	14	9/16	19.3
6	1/4	FE-6-2	29.3	23.7	15.3	5.0	17	9/16	21.7
6	3/8	FE-6-3	32.0	26.4	15.3	5.0	22	9/16	24.4
6	1/2	FE-6-4	35.2	32.6	15.3	5.0	27	9/16	27.6
8	1/8	FE-8-1	28.6	19.3	16.2	6.0	14	5/8	20.8
8	1/4	FE-8-2	31.0	23.7	16.2	6.0	17	5/8	23.2
8	3/8	FE-8-3	33.7	26.4	16.2	6.0	22	5/8	25.9
8	1/2	FE-8-4	36.9	32.6	16.2	6.0	27	5/8	29.1
10	1/8	FE-10-1	31.6	23.7	17.2	8.0	17	19	23.7
10	1/4	FE-10-2	31.6	23.7	17.2	8.0	17	19	23.7
10	3/8	FE-10-3	34.3	26.4	17.2	8.0	22	19	26.4
10	1/2	FE-10-4	37.5	32.6	17.2	8.0	27	19	29.6
12	1/8	FE-12-1	36.7	25.0	22.8	10.0	20	7/8	27.0
12	1/4	FE-12-2	36.7	25.0	22.8	10.0	20	7/8	27.0
12	3/8	FE-12-3	36.1	26.4	22.8	10.0	22	7/8	26.4
12	1/2	FE-12-4	39.3	32.6	22.8	10.0	27	7/8	29.6
12	3/4	FE-12-6	49.2	41.0	22.8	10.0	34	7/8	39.5
14	1/8	FE-14-1	36.9	26.0	24.4	12.0	24	25	26.5
14	1/4	FE-14-2	36.9	26.0	24.4	12.0	24	25	26.5
14	3/8	FE-14-3	36.9	26.0	24.4	12.0	24	25	26.5
14	1/2	FE-14-4	40.0	32.6	24.4	12.0	27	25	29.6
14	3/4	FE-14-6	49.9	41.0	24.4	12.0	34	25	39.5

FE Female Elbow

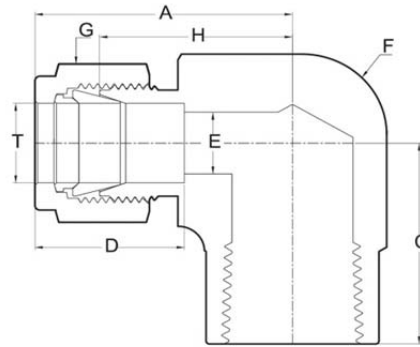

Metric

TUBE O.D.	FEMALE PIPE SIZE	ITEM NUMBER	A	C	D	E	F	G	H
15	1/8	FE-15-1	37.0	26.0	24.4	12.0	24	25	26.5
15	1/4	FE-15-2	37.0	26.0	24.4	12.0	24	25	26.5
15	3/8	FE-15-3	37.0	26.0	24.4	12.0	24	25	26.5
15	1/2	FE-15-4	40.1	32.6	24.4	12.0	27	25	29.6
15	3/4	FE-15-6	50.0	41.0	24.4	12.0	34	25	39.5
16	1/8	FE-16-1	37.0	26.0	24.4	14.0	24	25	26.5
16	1/4	FE-16-2	37.2	26.0	24.4	14.0	24	25	26.5
16	3/8	FE-16-3	37.2	26.0	24.4	14.0	24	25	26.5
16	1/2	FE-16-4	40.3	32.6	24.4	14.0	27	25	29.6
16	3/4	FE-16-6	50.2	41.0	24.4	14.0	34	25	39.5
18	3/8	FE-18-3	40.0	32.6	24.4	16.0	27	30	29.6
18	1/2	FE-18-4	40.0	32.6	24.4	16.0	27	30	29.6
18	3/4	FE-18-6	49.9	41.0	24.4	16.0	34	30	39.5
20	3/8	FE-20-3	43.7	34.7	26.0	18.0	30	32	34.7
20	1/2	FE-20-4	43.7	34.7	26.0	18.0	30	32	34.7
20	3/4	FE-20-6	48.5	41.0	26.0	18.0	34	32	39.5
22	3/8	FE-22-3	44.0	34.7	26.0	18.0	30	32	34.7
22	1/2	FE-22-4	44.0	34.7	26.0	18.0	30	32	34.7
22	3/4	FE-22-6	48.8	41.0	26.0	18.0	34	32	39.5
25	1/2	FE-25-4	52.9	41.0	31.3	22.0	34	1-1/2	40.5
25	3/4	FE-25-6	52.9	41.0	31.3	22.0	34	1-1/2	40.5

FE Female Elbow

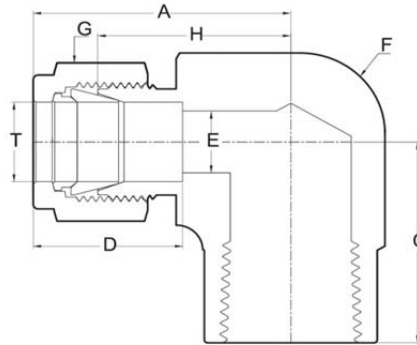

Fractional

TUBE O.D.	FEMALE PIPE SIZE	ITEM NUMBER	A	C	D	E	F	G	H
1/8	1/8	FE-01-1	25.2	19.3	12.7	2.5	14	7/16	18.3
1/8	1/4	FE-01-2	27.6	23.7	12.7	2.5	17	7/16	20.7
1/8	3/8	FE-01-3	30.3	26.4	12.7	2.5	22	7/16	23.4
1/8	1/2	FE-01-4	33.5	32.6	12.7	2.5	27	7/16	26.6
1/4	1/8	FE-02-1	27.1	19.3	15.2	5.0	14	9/16	19.3
1/4	1/4	FE-02-2	29.5	23.7	15.2	5.0	17	9/16	21.7
1/4	3/8	FE-02-3	32.2	26.4	15.2	5.0	22	9/16	24.4
1/4	1/2	FE-02-4	35.4	32.6	15.2	5.0	27	9/16	27.6
3/8	1/8	FE-03-1	29.0	19.3	16.8	7.7	14	11/16	21.3
3/8	1/4	FE-03-2	31.4	23.7	16.8	7.7	17	11/16	23.7
3/8	3/8	FE-03-3	34.1	26.4	16.8	7.7	22	11/16	26.4
3/8	1/2	FE-03-4	37.3	32.6	16.8	7.7	27	11/16	29.6
1/2	1/8	FE-04-1	36.9	25.0	22.9	10.0	20	7/8	27.0
1/2	1/4	FE-04-2	36.9	25.0	22.9	10.0	20	7/8	27.0
1/2	3/8	FE-04-3	36.3	26.4	22.9	10.0	22	7/8	26.4
1/2	1/2	FE-04-4	39.5	32.6	22.9	10.0	27	7/8	29.6
1/2	3/4	FE-04-6	49.4	41.0	22.9	10.0	34	7/8	39.5
5/8	3/4	FE-05-6	49.9	41.0	24.4	14.0	34	25	39.5
3/4	1/8	FE-06-1	40.5	32.6	24.4	16.0	27	1-1/8	29.6
3/4	1/4	FE-06-2	40.5	32.6	24.4	16.0	27	1-1/8	29.6
3/4	3/8	FE-06-3	40.5	32.6	24.4	16.0	27	1-1/8	29.6
3/4	1/2	FE-06-4	40.5	32.6	24.4	16.0	27	1-1/8	29.6
3/4	3/4	FE-06-6	50.4	41.0	24.4	16.0	34	1-1/8	39.5
1	1/2	FE-08-4	52.9	41.0	31.2	22.0	34	1-1/2	40.5
1	3/4	FE-08-6	52.9	41.0	31.2	22.0	34	1-1/2	40.5